

LET COUNTY DRAPERIES BE AN INTEGRAL PART OF YOUR OVERALL ENERGY AND COST SAVING WIRELESS GREEN ROOM.

Motorized window treatments enhance the operational experience of any room. These automated features permit designers to achieve their vision for both elegance and an eco-friendly environment. These systems function with Roman and Roller Shades as well as Pinch Pleat, Ripplefold and Accordia-fold treatments with center or side draws, on tracks that are straight or curved. Regardless of the fabric type or weight, there are practical and reliable solutions for every application that provide privacy and glare-reduction at the press of a button.

For increased energy efficiency and reduced electrical consumption, motorized window treatments are a great solution. Along with these advantages, they allow hoteliers to offer an easy to use, high-tech amenity that distinguishes their property from the competition.

Guests benefit from a feature that speaks to luxury as well as a commitment to eco-conscious sophistication.

County has partnered with Somfy and other manufacturers to offer individual and group controls that easily integrate with third-party systems allowing properties to determine when window treatments should be opened or closed in common areas and restaurants, protecting interior furnishings during peak sun hours and creating an optimal natural light environment throughout the day. Integration also allows for installations to evolve as new areas are updated or networked. From the Check Out desk, employees can automatically close the drapes, adjust the room's thermostat, turn off the lights and television, for total control over electric use. The result – motorization that supports conservation and rewards your bottom line.

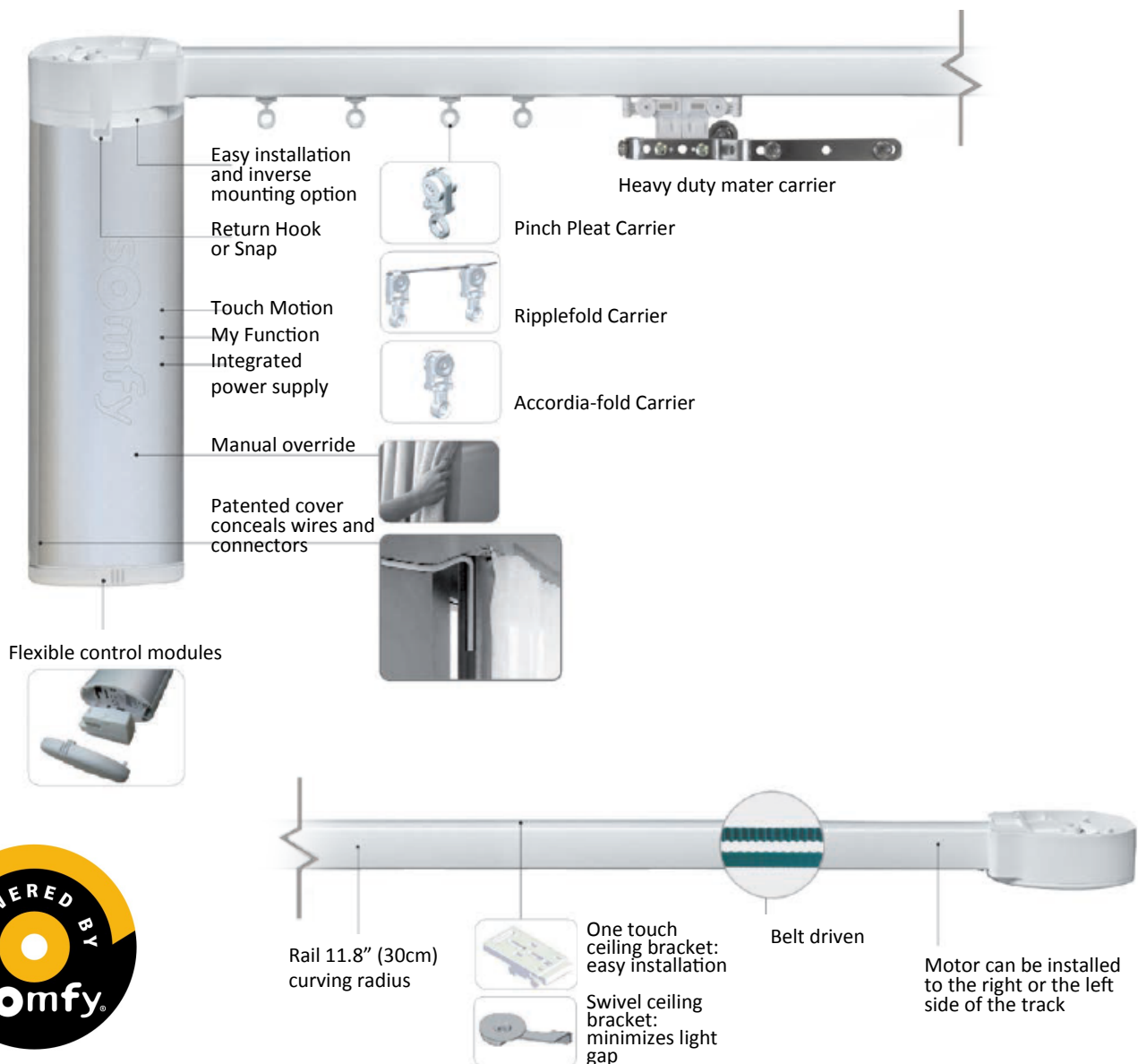

The simple, plug-in system installs easily and is maintenance-free. The commercial grade components feature the latest technology to ensure long-lasting, smooth and ultra-quiet performance. The touch control feature starts the drapery in motion but the system can function manually as well.

The Glydea™ System by Somfy accommodates Pinch Pleat, Ripplefold and Accordia-fold draperies and provides superior performance, reliability and ease of operation.

The Glydea™ motorized track is available in widths up to 36 feet and with a traversing capacity of up to 132 lbs.

Glydea™ 60e Track Characteristics

Power Supply	90 V to 250 V, 50/60 HZ
Amperage	1A
Average Linear Speed	4.9 in/sec to 7.9 in/sec
Power Consumption	120 W
Power Cable Type	3-wire cable
Control Connector Type	RJ12
DCT Control Circuit Voltage	3.3 VCD
Motorized Track Noise Level	< 44 dB at 5.9 in/sec
Certifications	c TUV US, CCC, CE
Track Maximum Length	36 ft
Maximum Number of Junctions	2
Minimum Bending Radius	11.8 in.
Minimum Curving Radius	11.8 in.
Maximum Weight (Side or Center Opening)	132 lbs./19.6 ft.
Tandem Maximum Weight	Consult Factory

Motor Unit Main Features

Soft Start	✓
Manual Operation	✓
Automatic Limits on End Stop	✓
Soft Stop	✓
Intermediate Position	✓
Touch Motion	✓
Adjustable Limits	✓
Speed Control & Adjustment	✓

Available Rail Bends using the Glydea™ System

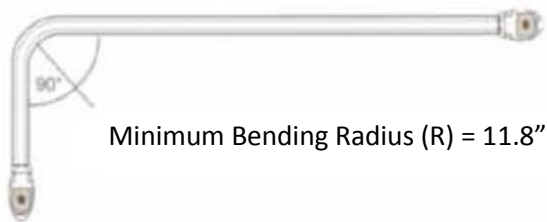

Minimum Bending Radius (R) = 11.8"

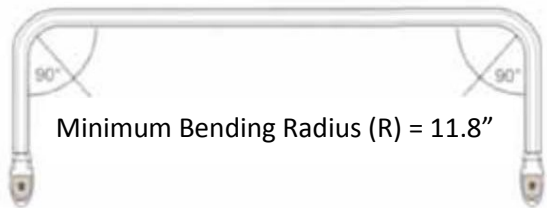

Minimum Bending Radius (R) = 11.8"

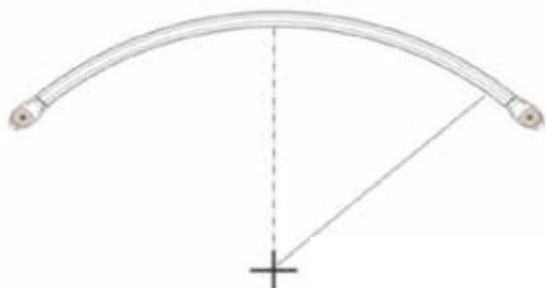

Minimum Bending Radius (R) = 11.8"

Control Options

3 Normally Open Dry Contacts	✓
2 Normally Open Dry Contacts	✓
2 Normally Open Dry Contact Sequencing Mode	✓
Dry Contact Individual and Group & Master Control	✓
Tandem	✓
RS485 Digital Technology	✓
Radio Technology Somfy® RTS	✓
ZigBee®	✓
Z-Wave®	✓
Sun Control	✓
Timer Control	✓
Infrared	✓

Tracks/Drapery Types

Side Opening	✓
Center Opening	✓
Asymmetric	✓
Multiple	✓
Pinch Pleat	✓
Ripplefold	✓
Accordia-fold	✓

Glydea™ Motor Unit Dimensions

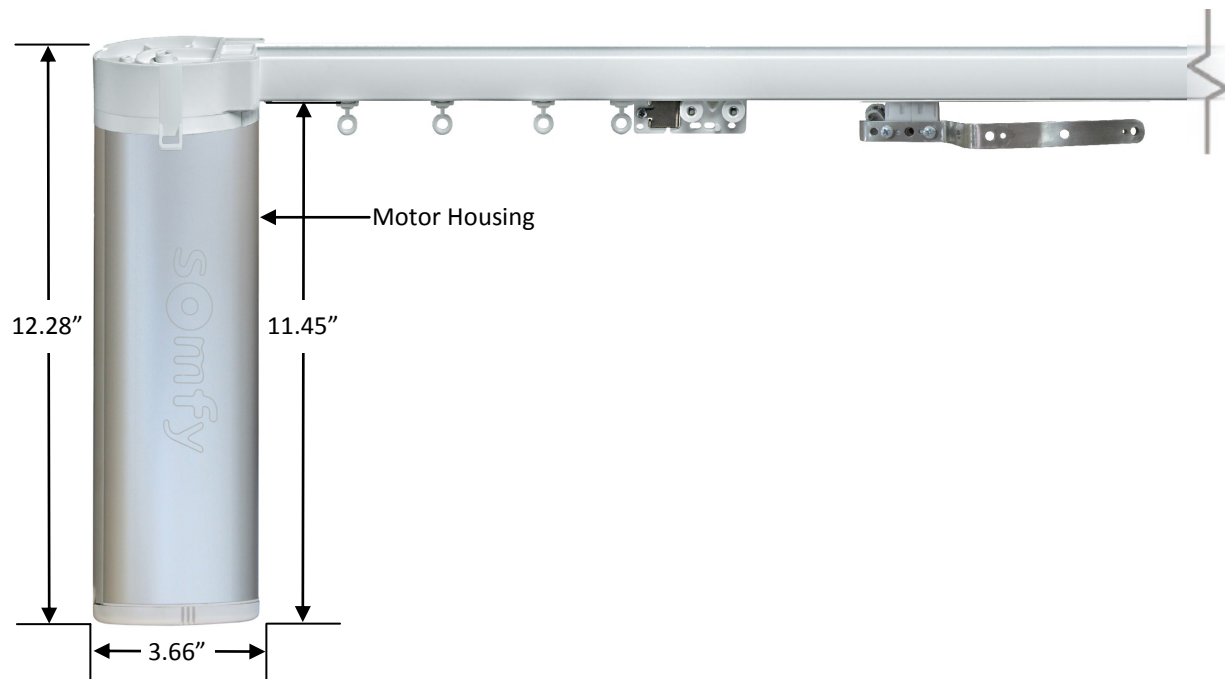

For use with Roman Shades, Solar Shades and Horizontal Blinds,
County offers Somfy's Sonesse™ line of motors.

There are three motor sizes available and the appropriate motor will be determined, based on the size of the treatment and weight of the fabric being used.



Sonesse™ 50 Motor

Quiet Operation	✓
Minimum Tube Size for Sonesse™ 30 and 40 Motors	1.5"
Minimum Tube Size for Sonesse™ 50 Motors	2"
Amp Requirement for Sonesse™ 30 Motors	1.66
Amp Requirement for Sonesse™ 40 and 50 Motors	2
Sonesse™ 30 Motor	Plug-in 24V DC
Sonesse™ 40 and 50 Motors	110 V AC motor, In-Wall Wired or Plug-in
Radio Technology Somfy® RTS - 30, 40 and 50 Motors	✓
ZigBee® - Sonesse™ 30 and 50 Motors	✓
Z-Wave® - Sonesse™ 30 and 50 Motors	✓

Wireless Wall Switches for Glydea™ and Sonesse™ are available in white, ivory and black and with up to 5 buttons. To identify the treatment to be open/closed or raised /lowered, the buttons may be ordered with labels.



Labeling terms are available by treatment type: Drapery, Sheer, Blackout, Blinds and Shades. Or by location of window: Lobby, Bedroom, Bathroom, Office, Conference Room, Theater, Dining Room, Sun Room and Balcony.

For guestroom applications remote controls are not recommended, but options are available. Consult factory. Remote Controls are often preferred for conference rooms, public spaces and administrative areas.

