

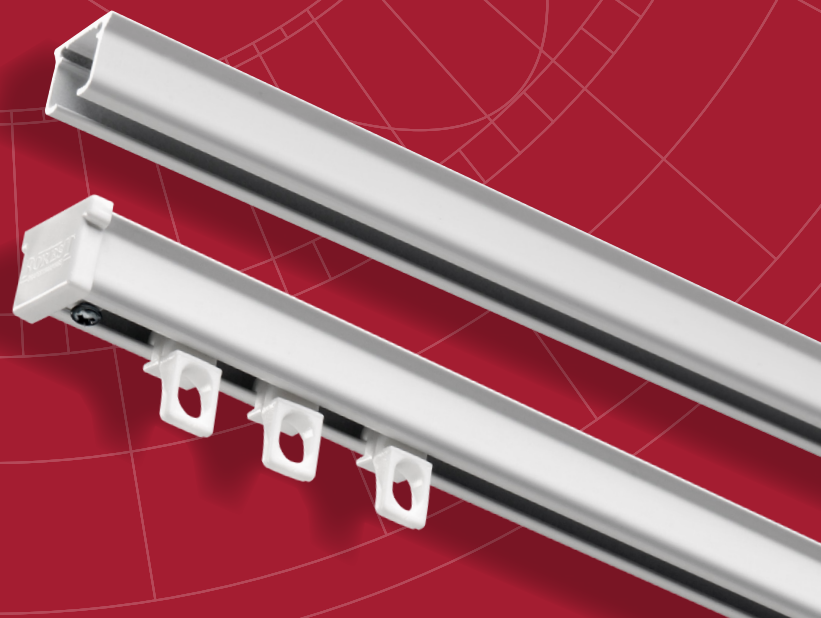

KS® TRACKS *Klick System*

Highly efficient hand drawn system for all types of medium and light weight draperies.
Quick installation with "Smart Klick" brackets for wall and ceiling applications.

THE WORLD BEHIND
your **DRAPERIES...**





PRODUCT INFORMATION

- Highly efficient hand drawn system for all types of light to medium weight draperies.
- Quick installation with “Smart Klick” brackets for wall and ceiling applications plus optional cover caps that conceal the screws.
- Bendable - KS can be curved and reversed curved using a 4” radius or continuous curve.
- Suitable for special window shapes such as circular, arched and triangular.
- Heavy duty clickable carriers are UV-protected and offer smooth, easy traversing. Shape is offset so pleats hang straight.
- Can also be used with ripplefold and accordiafold drapery.
- Maximum fabric weight: 3 lbs per foot.
- Finish colors available: white, black, brown, and silver.
- Available lengths: 13’1”, 16’4”, and 19’8”.
- Track finish: chromated powder coating with a factory applied patented dry lubricant.

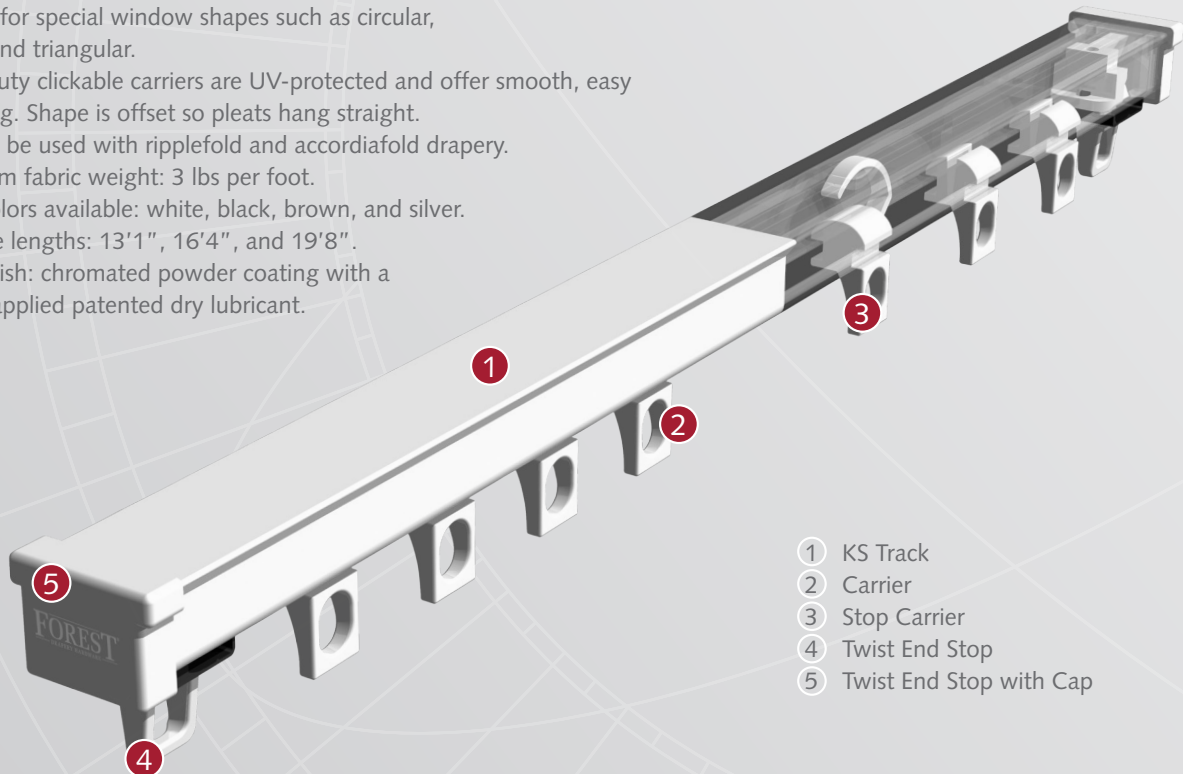

- ① KS Track
- ② Carrier
- ③ Stop Carrier
- ④ Twist End Stop
- ⑤ Twist End Stop with Cap



PROFILE

- Weight: 1.62 ounce per ft.
- Aluminum Extrusion
- Dimensions: 3/4" x 1/2"

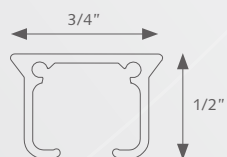

FOR USE IN

Hotels, offices, universities, healthcare facilities or at any location where an efficient hand drawn system is required.

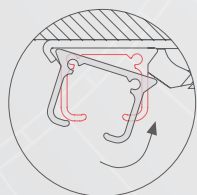

Easy installation
click - position - tighten

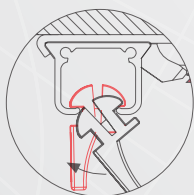

clickable carrier



BENDING / CURVING

The track can be curved and reversed curved using a 6" or 8" radius. Continuous curving is also possible with the electrical bending tool. Actual size template is required.



APPLICATIONS

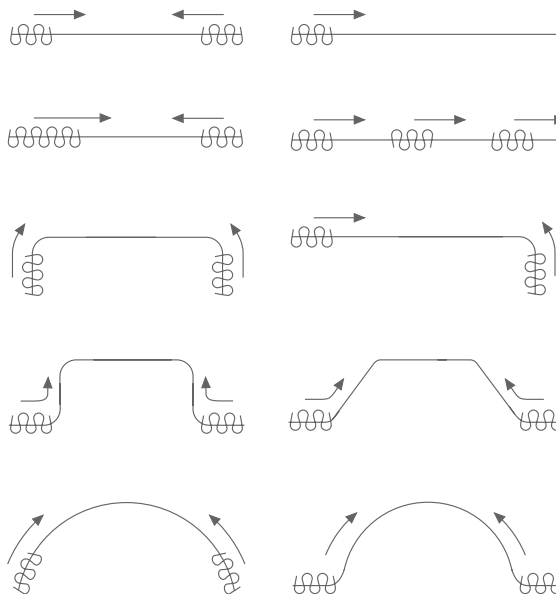

MOUNTING BRACKETS

Brackets need to be placed every 24".

Heavy Duty Ceiling Bracket with Smart Klick 3003-XX

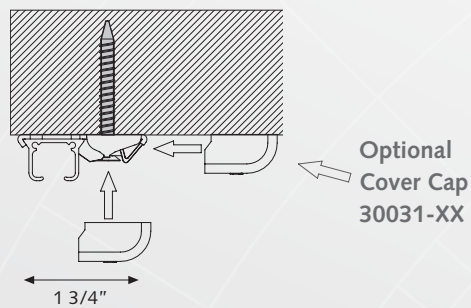

3" Smart Klick Wall Bracket 53202-XX

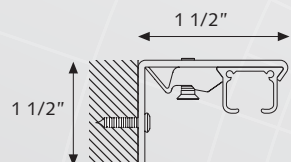

6" Smart Klick Double Wall Bracket 53206-XX

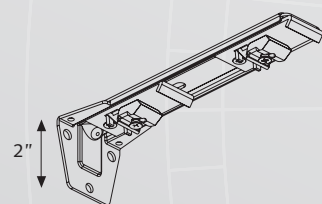

3" Wall Bracket for Wood Poles 3280-XX

A) 3" B) 2 1/2"

A) 5" B) 4 1/2"

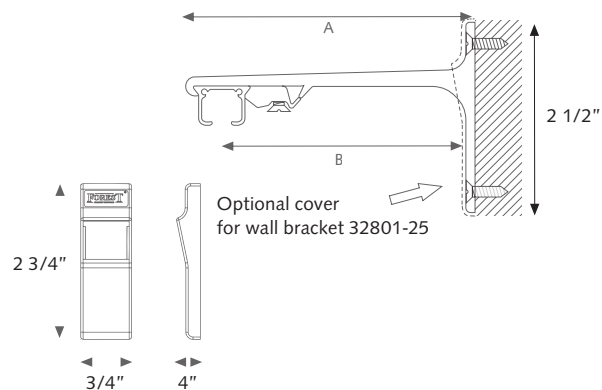

6" Double Wall Bracket for Wood Poles 3281-XX

A) 6" B) 3 5/8" C) 1 3/4"

A) 8" B) 3 5/8" C) 3 3/4"

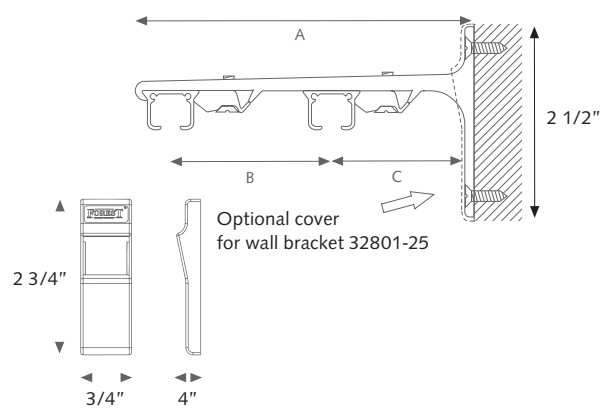

10" Triple Wall Bracket for Wood Poles 3284-25

A) 10" B) 3 3/4" C) 2"

